

**Giant lifting  
height  
and reach**

# SL 780 Outdoor Giant

Another rough terrain machine  
for outdoor and indoor use

## Lifts and handles almost a ton

Large window sections for  
your new building is easily  
and precisely lifted by the  
SL 780 Outdoor Giant.



- 2 vacuum circuits with 2 pumps
- For rough terrain with frontwheel drive and big wheels. Electronic brake
- Maneuverable with dual rear wheels
- Lifting height 157.6 (center of yoke)
- Remote control for all hydraulic functions
- Waterproof according to ip65



*The wide tires  
make the machine  
extremely suitable  
for cross-country  
use*

*The Smartlift  
shows its strength*



*The Smartlift is  
easily transported  
in a van or on  
a trailer*



4910 Wilshire Boulevard • Country Club Hills, IL 60478  
Phone: 815-931-4825 • [www.greatlakeslifting.com](http://www.greatlakeslifting.com)

**Smart Lift**  
DENMARK



# SL 780 Outdoor Giant

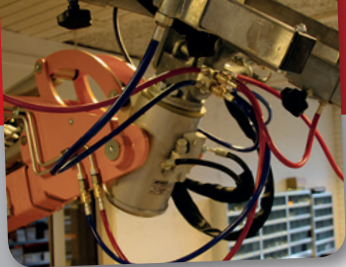

The multifunctional, hydraulic rotary head



The Smartlift has side shift for exact adjustment of the window



The Smartlift has hydraulic movements in all directions



Remote control for all hydraulic functions

## Technical data

Description	Value
Total weight	2867 Lb
Total height	61.1 in
Total width (min)	39.8 in
Total length (min)	111.1 in
Telescoping of arm	2 x 32.7 in
Speed regulation	Stepless high/low
Side shift	3.9 in
Vacuum system	2 circuits
Lifting height, ceiling installation	173.4 in
Charging voltage	115 volt
Integrated charger	
Charging time 25-100%	Approx 10 hours
Batteries (4 x 12 v) 24 volt	4 x 134 Ah
Running period	Approx 8 hours
Frontwheel drive	2.68 hp
Brake	Electric
Suctions pads	4 x Ø 15,75 in and 2 x Ø 11,8 in
Automatic suction	2 vacuum pumps
Lifting capacity, telescopic arm in/extended	1819 lb/595.4 lb

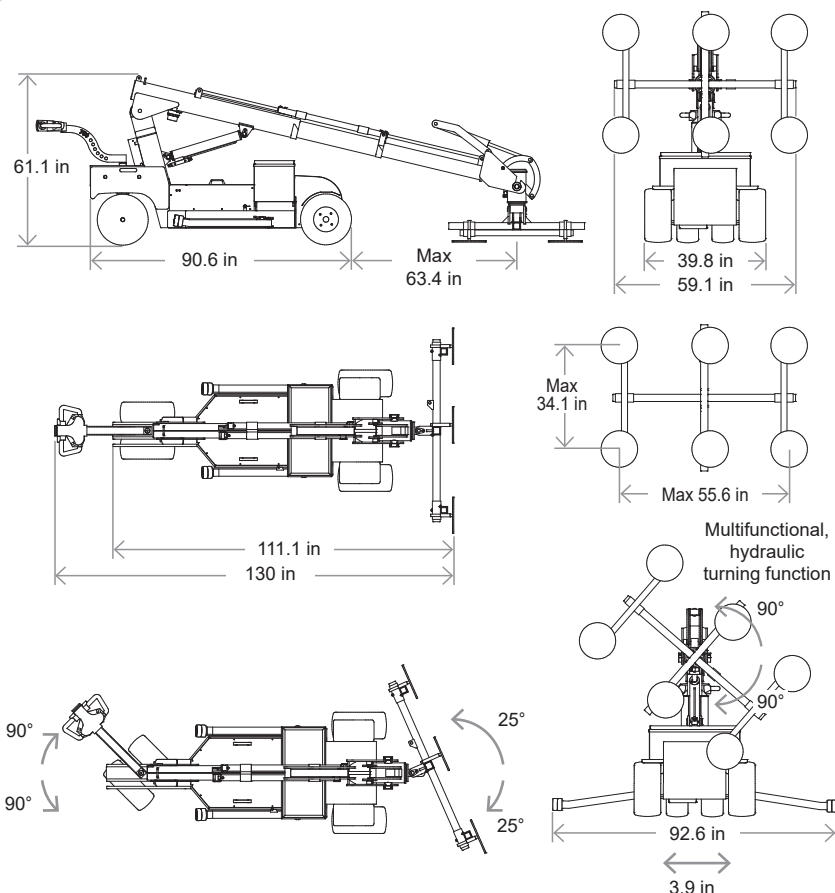
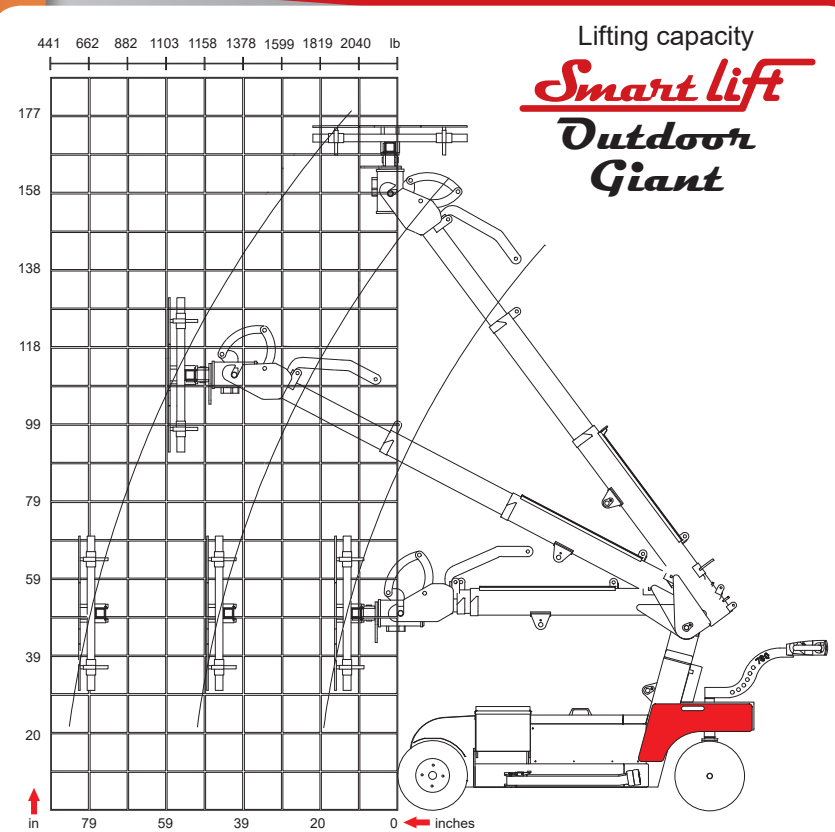

4910 Wilshire Boulevard • Country Club Hills, IL 60478  
Phone: 815-931-4825 • [www.greatlakeslifting.com](http://www.greatlakeslifting.com)

